



FACT RCF BUILDING PRODUCTS LIMITED

(A Joint Venture of FACT & RCF, Both Government of India Enterprises)
AMABALAMEDU.P.O, KOCHI, 682 303.

EXPRESSION OF INTEREST

FRBL/EOI/2016-11

26-11-2016

FRBL, invites expression of interest from suppliers, agents or manufactures to supply the following chemicals/consumables required for its GFRG panel production. (1) water repellent compound in liquid form (2) Retarder Dissolvine D 50 (3) Fibre Glass Rovings assembled CR 2080, 2400 Tex (4) Core plug seal – thermo plastic rubber (5) GFRG Panel cutting blade (6) timing belt -560-RPP8-20 mm width (7) servo level gauge for LPG storage tanks. The last date for receipt of expression of interest is 15-12-2016. Detailed specification, quantity requirement, terms & conditions are available at our website www.frbl.co.in. Any addition, deletion or corrigendum will be published in our website only.

-sd/-
Managing Director
FRBL

REQUIREMENT OF SPECIAL CHEMICALS / RAW MATERIALS ETC.

Sl. No.	ITEM	General description	Approx. qty. per year
1	Water repellants for the manufacture of GFRG panels	Masonry water repellent in liquid form - Polymethyl hydrogen siloxane (Equivalent to SILRESS BS 94 of Wacker Chemicals)	60 MTs
2	Retarder Dissolvine D 50 for the manufacture of GFRG panels	Diethylenetriaminepentaacetic acid pentasodium salt solution (Equivalent to D 50 of Akzo Nobel Functional Chemicals)	22 MTs.
3	Fibre Glass Rovings for the manufacture of GFRG Panels	Assembled rovings CR 2080, 2400 Tex	120 MTs.
4	CORE PLUG SEAL - Material : thermoplastic rubber	3550mm x 39 mm. as per Drawing, 70 to 75 shore 'A' hardness, Design temperature 100 Deg.C	1400 Nos.
5	GFRG Panel cutting blades	Cutting wheels – 250 mm dia, bore-25mm, Teeth 80T” , tooth style-TCG, (equivalent to Suzuki make)	60 Nos.
6	GFRG Panel cutting belts	TIMING BELT - 560 – RPP8- 20mm width MEGADYNE make	200 Nos.
7	Servo level gauge for LPG storage tanks	Digital controlled electronics servo balancing type .	2 Nos.

Remarks: Items 1 to 4 from a new supplier (not tried at FRBL) need to be tested & Commercial trials to be carried out before including as regular suppliers.

DATA SHEET		SERVO GAUGE FOR LPG STORAGE BULLETS
01	Tag Nos	LT901B and LT902B
02	Service	LPG Level Measurement
03	Vessel No	901 and 902
04	Fluid / State	Liquid / Gas
05	Level Min-Max	0-2850mm
06	Measuring accuracy	<=1mm

07	Sensitivity	<=1mm
08	Pressure Normal / Maximum	0 / 18
09	Process Temperature Normal / Maximum degree C	20 / 30
10	Density of LPG Liquid in Kg/Cubic Metre	525 to 580 @ 15 deg.C
11	PROCESS CONNECTION FLANGE	6inch, 300RF, ASME B16.5
12	FLOAT material & Wire material	Suitable for service (manufacturer to select)
13	Power Supply	110 VAC, 50 Hz
14	Level Output	4-20 mA DC + HART
15	Local Indication	INTEGRAL, DIGITAL
16	Temperature Sensor	NOT REQUIRED. 3 Wire PT100 RTD- already available at site.
17	Transmitter Enclosure Protection	Explosion proof.
18	REMOTE / PUMP HOUSE INDICATORS	NOT REQUIRED.
19	6 inch Perforated Stilling Well,	ALREADY PROVIDED IN THE TANK.
20	6 inch / 300# Isolation Ball Valve	ALREADY PROVIDED ON THE TANK.
21	Calibration Chamber	REQUIRED. Please quote.
22	Existing LPG Storage Tank Bullet Dimensions	See Drawing Attached.
23	Commissioning Assistance	REQUIRED. Please quote.
24	Necessary approval / calibration certificates	REQUIRED.

Drawing attached.

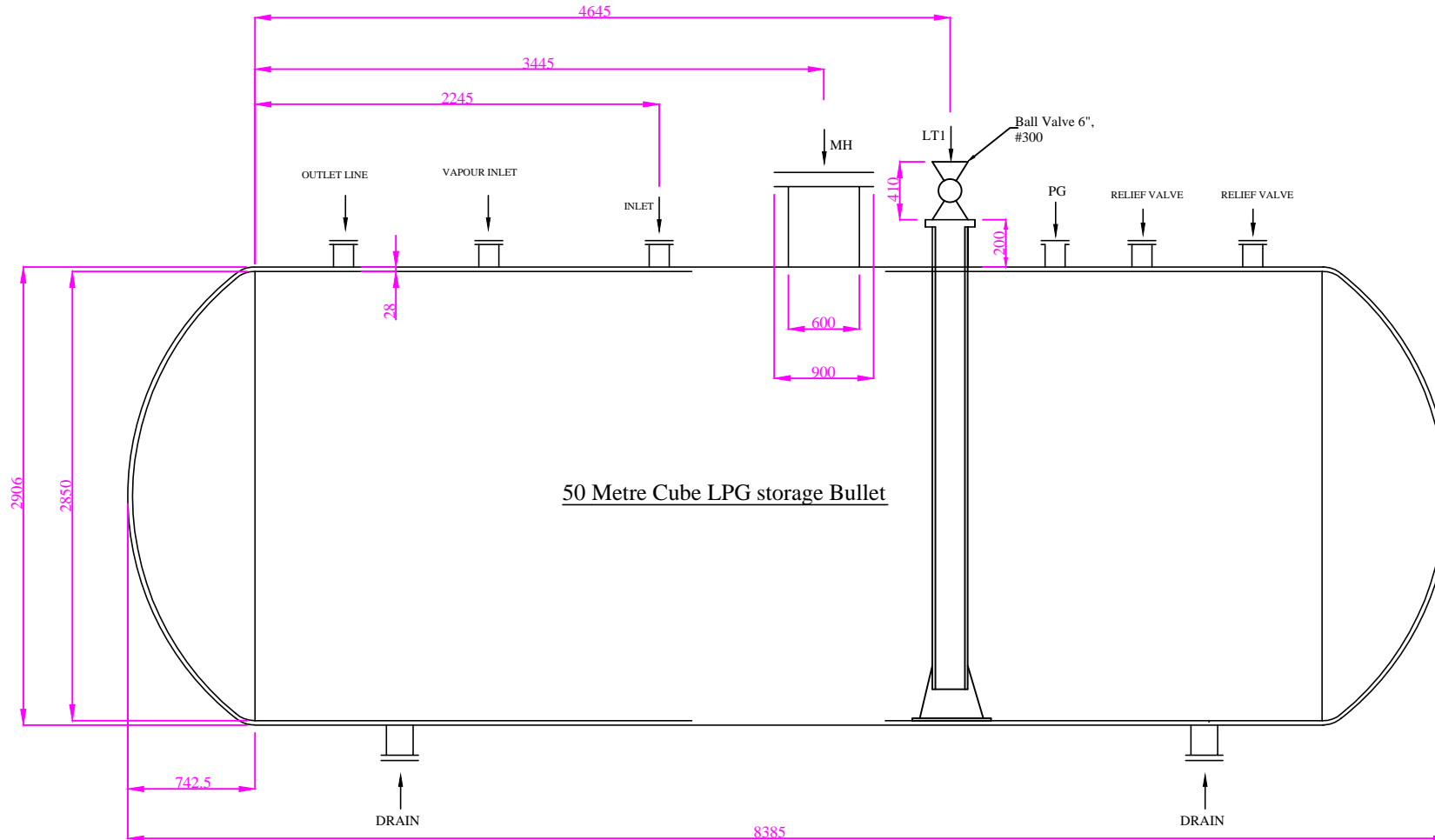

NOZZLE SCHEDULE									
NOZZLE MARK	SIZE (NB)	SCH./THK.	RATING	TYPE FLANGE	FACE	STD.	QTY.	PROJECTION	DESCRIPTION
L1	150	80	300	WN	RF	ANSI B16.5	1	200	LEVEL TRANSMITTER WITH BLIND FLANGE

FACT-RCF BUILDING PRODUCTS LTD

C:\Users\FRBL\Documents\frmg.gif

SCALE : NOT TO SCALE REV : 0

MATL. :

ALL DIMENSIONS ARE IN MM
UNLESS OTHERWISE SPECIFIED.

This document is confidential. Its issue represents a confidential disclosure of the information contained therein. It is provided on the basis that it will not be used for any purpose, duplicated in any form or disclosed to third parties without the express written authorisation of FACT-RCF Building Products Ltd.

TITLE:- LPG LEVEL TRANSMITTER
MOUNTING DETAILS

DRG NO.:
FRBL-IN-900-15-028

DWN BY : JTN DT : 23-01-15
CKD BY : AKS DT : 23-01-15
APP BY : MKR DT : 23-01-15

SHEET : 1 OF 1

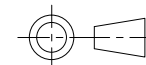



FACT-RCF BUILDING PRODUCTS LTD (FRBL)

A JOINT VENTURE OF FACT, COCHIN & RCF, MUMBAI

Regd. Off: Eloor, - Udyogamandal-683501, Kochi, Kerala

Address all correspondence to

FACT-RCF Building Products Ltd.,

FACT –C D Campus, Ambalamedu,

Pin: 682 303, Cochin, Kerala

Ph: 0484-27200020

Email: frblmaterials@gmail.com

CONDITIONS

- 1. The bidder must confirm that the material shall be as per specification and Test Certificates shall be submitted.**
- 2. Sample quantity need to be supplied when required for testing.**
- 3. If the initial testing is OK, the products need to be tested for commercialization.**
- 4. In the case of sample testing quantity, exemption shall be given for existing suppliers whose consumption ratios are already known.**
- 5. Price evaluation shall be done on the basis of actual consumption rates obtained by us per Panel after testing the samples on commercial trail basis.**
- 6. Preliminary testing of sample as well as commercial trials shall be conducted by the quality control department of FRBL, which shall be final.**
- 7. MSDS with CAS number shall be submitted.**
- 8. Copies of recent purchase orders executed for same/ similar grade to be attached.**
- 9. Delivery required at FRBL, FACT COCHIN DIVISION, AMBALAMEDU – 682 303.**

	COMMERCIAL SPECIFICATION	TERMS AND CONDITIONS OF PURCHASE	10CS011R1/2010
			PAGE 1 OF 1
<p style="text-align: center;">C O N T E N T S</p> <p>1.0.0 STANDARD TERMS</p> <p>2.0.0 SELLER'S GUARANTEE / WARRANTY</p> <p>3.0.0 PRICES</p> <p>4.0.0 TERMS OF PAYMENT</p> <p>5.0.0 INSPECTION AND TESTING</p> <p>6.0.0 DELIVERY / SUPPLIER'S DEFAULT</p> <p>7.0.0 SETTLEMENT OF DISPUTE</p> <p>8.0.0 OTHER TERMS & CONDITIONS.</p>		<p>5.0.0 INSPECTION AND TESTING</p> <p>5.1.0 Supply / despatch shall commence only after clearance of the sample for each lot.</p> <p>5.2.0 Notwithstanding any inspection/sample testing that may have been done at the supplier's shop/godown or before despatch, final acceptance of the stores is subject to inspection of the supply received at FRBL.</p> <p>6.0.0 DELIVERY / SELLERS'S DEFAULT</p> <p>6.1.0 The Purchaser may cancel the order or take suitable alternative action at any time, if in his opinion, the seller is not proceeding in a satisfactory manner in the execution of the order. Such action will be at the cost and risk of the seller.</p> <p>6.2.0 Timely Delivery is the essence of Contract. The Purchaser reserves the right to claim Price reduction (liquidated damages) for delayed delivery @ 1% PER WEEK or part thereof of delay subject to a MAX. 10% OF ORDER VALUE. Seller shall Invoice for the supply price less the price reduction due to delay.</p> <p>6.3.0 For delivery reckoning, the date of LR / RR shall be taken. Weightment will be done at FRBL also. The least weight as per FRBL weigh bridge or Invoiced weight whichever is less will be considered for payment.</p> <p>7.0.0 SETTLEMENT OF DISPUTE & JURISDICTION</p> <p>In all cases of disputes, the decision of the Chairman and Managing Director of FRBL shall be final. Jurisdiction : Udyogamandal/Kochi</p> <p>8.0.0 Other Terms & Conditions</p> <p>8.1.0 Variation in rate / introduction of new statutory taxes / duties during the contractual delivery period only to FRBL's account.</p> <p>8.2.0 Test Certificates / Guarantee /Warranty certificate etc shall be submitted along with supply.</p> <p>8.3.0 CENVAT documents shall be furnished.</p> <p>8.4.0 Supplier shall indemnify FRBL of any claim / demand towards infringement of any patent / copyright / royalty in the use of the supplies.</p> <p>8.5.0 Force Majeure conditions limited to War, Riot or civil commotion, any statutory restriction imposed & any natural physical disaster.</p>	
<p>-----</p> <p>1.0.0 STANDARD TERMS</p> <p>1.1.0 All Central, State or Municipal Taxes, duties and other statutory levies, packing, forwarding & handling charges, Freight charges etc. will be assumed to be included in the price unless otherwise separately shown.</p> <p>1.2.0 Transit Insurance shall be in FRBL's scope, provided supplier intimates FRBL's Insurer in time, otherwise supplier shall be responsible for any damages in Transit.</p> <p>2.1.0 SELLER'S GUARANTEE / WARRANTY</p> <p>Supplier warrants the shelf life / performance of supplied material for a period of 12 months from the date of supply. Seller is responsible for replacing the material at his expenses, if material is found defective during the guarantee period.</p> <p>3.0.0 PRICES</p> <p>There shall be no revision in the price during the period of contract.</p> <p>4.0.0 TERMS OF PAYMENT</p> <p>4.1.0 100% payment shall be made within 30 days of receipt, inspection and acceptance of the material at FRBL/Site and against a Bank Guarantee in FRBL format for 10% order value as security valid for 12 months.</p> <p>4.2.0 Bank Guarantee shall be released only after the successful completion of Warranty period.</p>			

INFORMATION ABOUT BIDDER

[PLEASE USE ADDITIONAL SHEETS, IF SPACE IS INSUFFICIENT]

(FRBL reserves the right to verify the information given as per this format and enclosures. It is the responsibility of the party to give the full details asked for as per this format for evaluating his offer. Any misrepresentation of facts and withholding of information may result in disqualification. Please read instructions/ terms & conditions given herewith carefully. Strike off whichever is not applicable.)

I - GENERAL

1. Name & Address of the Firm:

2. Office Telephone No:

2.1 Office Fax No:

2.2 Mobile No. of concerned officer:

3. E-Mail id:

4. Constitution of the Firm: Proprietorship / Partnership / Pvt Ltd. Co / Pub. Ltd. Co./ Co-operative (Enclose certified copies of documents i.e. Partnership deed/ Articles of Association/ Memorandum of Association/ Bye-laws, Certificate of Registration etc as applicable)-

5. Year of establishment:

6. Name, Address and Telephone Nos. of Proprietor / Partners/ Directors:

Name:

Address:

.....

.....

Phone No (office):

Mobile Phone No.:

Fax no:

7. Details of persons who shall co-ordinate for execution of the order

Name:

Address:

.....

.....

Phone No (office):

Mobile Phone No.:

Fax no:

E-Mail id:

8. Name & designation of Authorised signatory :

(Enclose Authorisation Letter/Document)

II. EXPERIENCE OF PARTY :

1. Party shall have experience in trade of as specified material during the preceding three years.

No.	Name of the Client	Order Period	Item	Manufacturer	Weight In MT

Note: Documentary evidence in support of the above such as copies of orders / Experience certificate / Performance certificates etc., from Clients served shall be enclosed.

2. Whether your firm/company is blacklisted by FRBL / FACT / RCF or any other

Public Sector / Govt/ Quasi-Govt. Organisation / any other Client: **Yes / No**

4. Whether your contract was terminated before expiry of Contract **Yes / No**

period or Security Deposit / E.M.D. forfeited by FRBL / FACT/RCF

OR any other Public Sector / Govt./ Quasi-Govt. Organisation / any other Client

5. Whether Proprietor/Partner/Director (as applicable) has been

prosecuted by any Judicial Court for any criminal breach of trust **Yes / No**

NOTE:

(i) The blacklisted parties by FACT / FRBL/RCF or Govt./Quasi Govt. Organisation are liable for disqualification. FRBL decision will be final in this regard.

(ii) The parties whose EMD is forfeited by FACT/RCF are also liable for disqualification.

(iii) FRBL reserves the right not to consider parties having any dispute with FRBL / FACT/RCF in order to protect its interest.

III FINANCIAL WORTHINESS OF PARTY

1) Income Tax Permanent Account Number (PAN):

(Attach copy of PAN CARD).

2) Details of Profit & Loss Account

Sr. No.	Year	Total revenue	Receipts(Rs.)	Profit / loss(Rs.)
	2013-2014			
	2014-2015			
	2015-2016			

(Please enclose copies of Audited Profit & Loss Accounts and Balance sheets for the preceding at least three financial years as above).

IV. Declaration on Proprietor/Partners / Directors

Full Name of the Proprietor/Partner/Director

Name of the other firm(s) of which bidder is a proprietor / Partner/ Director

- 1
- 2
- 3
- 4
- 5

I / We hereby solemnly declare that the proprietor / Partner/ Director of this firm / company mentioned at Sl. No(s).above is / are **common / not common** (Strike off whichever is not applicable) with any other firm / company who has applied for against same advertisement. In case of common Proprietor / Partner / Director in other firm, who has also applied against same advertisement, please mention the name of the firm / firms.

Name of the Firm:

V. Declaration about relationship with Employee of FACT / RCF

I/ We hereby solemnly declare that the proprietor / one or more Partners /Directors of this firm/ company **has relationship / has no relationship** (Strike off whichever is not applicable) with any employee of FACT / RCF. In case of relationship, indicate details of employee in FACT / RCF:

VI. Following documents to be enclosed along with Expression of interest.

1. Experience certificate/work order copy/performance certificate from Clients.
2. Copies of Audited Balance sheets and Profit & Loss Accounts for the preceding Three financial years,
3. Copy of "Permanent Account Number" (PAN) Card.
4. Copy of Partnership deed/ Articles of Association/ Memorandum of Association/ Bye laws, Certificate of Registration etc as applicable).